



Commercial
Vehicles

VOLKSWAGEN AMAROK MK1&2 ALL MODELS
TRUCKMAN HARDTOP INSTALLATION MANUAL

TRUCKMAN GRAND PART Nos: ZGB2H2071(+paint code)

TRUCKMAN GLS PART Nos: ZGB2H20712(+paint code)



NOTE: Disconnect the vehicle battery prior to installation - Please refer to relevant technical bulletins. Check all wires are correct prior to connection. Ensure all harnesses are neatly & effectively cable tied in place. Check the vehicle condition and electrical systems before and after installation.



KIT CONTENTS

- 1 x Truckman hardtop
- 6 x Clamp locks
- 1 x Vehicle wiring warness
- 1 x Fuse extension wire
- 1 x Ring terminal extension wire
- 1 x Roll tailgate trotection tape
- 5 x Blue Duraseal connectors
- 1 x 5 Amp fuse

TECHNICAL HELP

Telephone: Autostyling UK Ltd 01384 485 405
Email: fitting@autostylinguk.com

PRE-INSTALLATION CHECKS

Carry out a visual check of the vehicle. Clean areas of bodywork that will come into contact with, or be obscured by the hardtop. Carry out a functional check and test of the vehicle systems prior to starting the installation, in particular, the areas to be worked on during the course of the installation.

LOAD BED LINERS

Truckman recommend that canopies are not fitted onto over-rail bed liners or spray on liners that cover the upper surface of the bed rails. The uneven surface of these products can result in a ineffective seal of the canopy to the vehicle body.

UNPACKING



1. REMOVE CARDBOARD SLEEVE

Carefully cut the bands and collect the corner protection.
 Remove the box lid then lift the cardboard sleeve over the canopy.
 Retain all packaging until installation and inspection are completed.

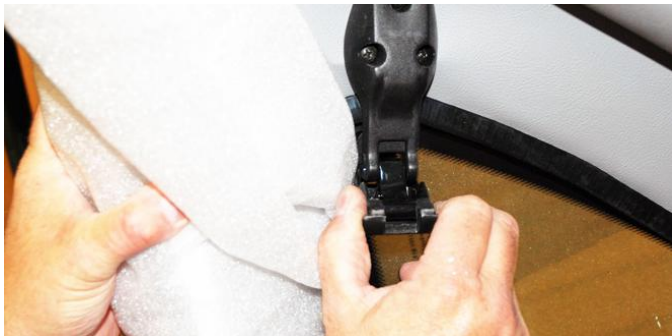

2. UNWRAP THE FOAM PROTECTION

For a Truckman Grand canopy, undo the side window catches to release the foam protection.
 Remove the keys from the inside of the rear door and retain.



3. RETRIEVE THE FITTING KIT

Open the catch on the bulkhead window then from under the packaging locate the boxed fitting kit and the 3 packages containing the components of the roof bars.

ELECTRICAL INSTALATION

OVERVIEW

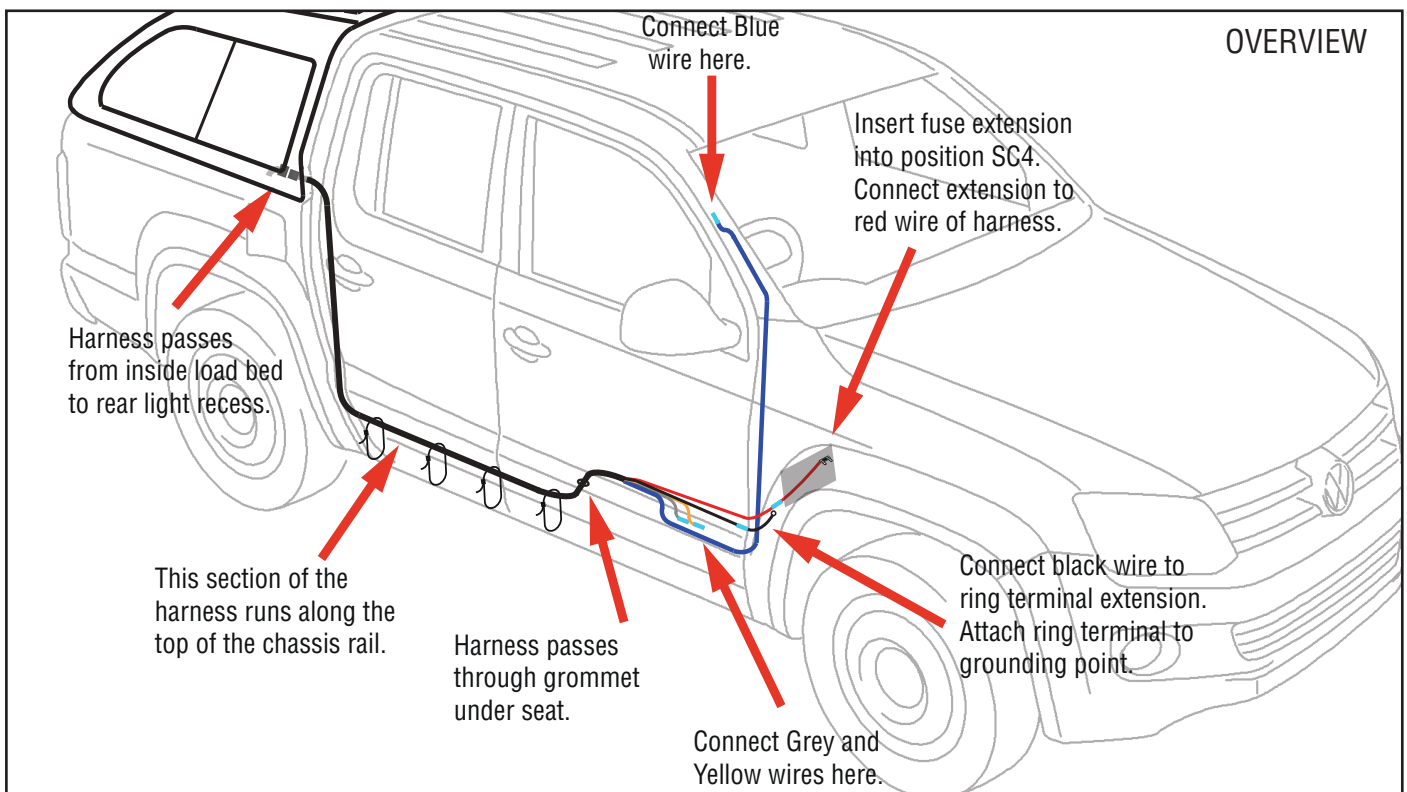

INSTALLATION NOTES

Ensure prior to installation that the vehicle is in neutral and the vehicle battery is disconnected. Do not re-connect the battery with the vehicle in gear.

Verify the connection points with an intrinsically safe, WV group approved multi-meter.

Where indicated, ensure all electrical connections are made using the approved VW Group methodology.

Re-apply protective tape to any section of the vehicle harness exposed during installation.

Always secure wiring harnesses away from moving parts or sources of heat.

Treat any drilled holes with appropriate anti corrosion paint.

VW COMMERCIAL VEHICLE CONNECTION METHODOLOGY

Refer to ELSA prior to making any electrical connections; all electrical connections must be carried out using the Duraseal methodology (see below)

- Place the heat shrink tubing over the terminal and allow 5mm overlap, heat seal using tool 1978/14 and shrink element 1978/15
- Repeat the operation to complete double insulation process.
- Cut wires intended for connection and strip back the insulation by 10mm.
- Twist the exposed cable, (where two wires enter the Duraseal Connector at the same end, twist the cable together and trim surplus to leave 6mm of exposed cable.
- Place the Duraseal connector in an approved crimping tool and insert the wire(s) into one end, apply pressure to the crimps and maintain the pressure for approximately 5 seconds after the jaws have closed.
- Repeat the process at the opposite end of the Duraseal connector.
- Using the Hot Air Blower 1978/14 and Shrink Element 1978/15, heat the Duraseal Connector until the sleeve seals at both ends of the connector.



4. CANOPY SECTION OF THE WIRING HARNESS

Remove the vehicle section of the harness from the fitting kit box.

Pass the end of the harness (with bare wires) through the round hole in the front right corner of the truck bed leaving approximately 100mm of the wires and plug inside the bed.

Run the harness down to the chassis and forward to below the driver's seat. Loosely attach with the large cable ties supplied.



5. UNDER THE VEHICLE

Make a hole in this grommet located under the Driver's seat.

Feed the end of the harness through the hole and into the interior, under the driver's seat.



6. INTERIOR

Un-clip the Driver's side sill cover and remove the front section of the door aperture seal.

Unclip and remove the kick panel to the right of the accelerator pedal.



7. INTERIOR (CONTINUED)

Under the driver's seat, draw the harness through the grommet and under the carpet to the door sill.

Remove a section of sheathing from the vehicle's wiring loom. Connect the remote locking wires using the table below as a guide. Refer to the sections on Connection Methodology.

WIRE COLOUR GUIDE AMAROK MK2 (2017-) FOR AMAROK MK1 (2013-2017) SEE PAGE 10			
HARDTOP	FUNCTION	VEHICLE	NOTES
YELLOW	Central Locking (Lock)	YELLOW	- Checked on a 66 plate Amarok Momentary +12V using the remote 'lock'. Momentary +12V using the remote 'Unlock'. +12V when brake pedal is depressed. Remove fuse and replace with extension. Connect ring terminal to distribution point.
GREY	Central Locking (Unlock)	WHITE	
BLUE	Brake Light	BLACK/ RED	
RED	Interior light	FUSE POSITION SC4	
BLACK	0V to ground	BODY GROUND.	



8. +VE WIRE CONNECTION

Unclip the fuse panel below/right of the steering column. Locate and remove the 5A fuse from position SC4.

Refit the fuse (and the 5A fuse from the fitting kit) into the fuse extension and then insert this into position SC4.

Connect the extension wire to the red wire in the hardtop harness removing any excess wire. Refer to the sections on Connection Methodology.

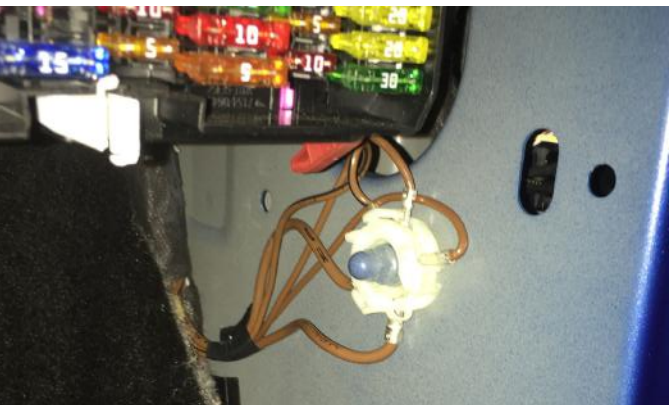

9. -VE WIRE CONNECTION

Take the ring terminal extension from the fitting kit box.

Locate the ground distribution point on the bodywork to the right of the accelerator pedal. Unscrew the nut and fit the ring terminal.

Connect the extension to the black wire of the hardtop harness. Refer to the sections on Connection Methodology.



10. 'A' POST CONNECTION

Carefully remove the 'A' post trim.

Feed the Blue wire up to the 'A' post and make a connection into the Vehicle's wiring harness as in the guide above. Remove any excess cable.

PREPARATION FOR FITTING



11. DISCONNECT THE 3RD BRAKE LIGHT

In order to prevent glare in the rear view mirror the 3rd brake light on the rear of the cab must be disconnected.

Un-clip the unit from the vehicle body. Squeeze the tags on the connector to withdraw it then refit the light leaving the wire and connector tidily inside the housing.

For information on flush fitting brake light see page 10



12. SEAL THE FRONT CORNERS OF THE BED

To achieve a flat mating surface for the canopy to sit on, apply sealant to the gap between the front and side rails of the vehicle body.

This can be done just prior to fitting the canopy so that the sealant is still 'wet' and will be moulded to shape by the canopy's rubber seal.

Tip: Use black sealant on dark coloured vehicles and clear on lighter colours.



13. PREPARE THE CLAMPS

Unwrap the 6 clamp locks from the fitting kit. Remove the plastic covers from the screw heads and completely undo them.

Note for reassembly, the two parts of the clamp interlock with a sliding dovetail.



14. CHECK THE CANOPY

Check that the canopy to vehicle seal is clean and dust free.

Make sure the rear door is fully closed and the slam locks are securely latched (left) prior to mounting the canopy on to the vehicle.

FITTING

NOTE: 4 people should be used to lift the canopy on to the vehicle. Vehicle tailgate should be shut.



15. LIFT THE CANOPY ON TO THE VEHICLE

Lift the canopy out of the packaging with 2 people holding the rear corners (not the door) and 2 people at the front corners. Carefully place the canopy on to the vehicle body so that the rear door is behind the tailgate. Note: Place the canopy down and not to 'drag' it.



16. POSITIONING THE CANOPY "A"

Check that the canopy is centralised side to side on the vehicle's bed.



17. POSITIONING THE CANOPY "B"

Adjust the position of the canopy so that the seal under the door is just in contact with the tailgate all the way across.



18. POSITIONING THE CANOPY "C"

Check that the lower part of the rear door is centralised in relation to the vehicle's tailgate.



19. POSITIONING THE CANOPY "D"

Check that the canopy and the vehicle bed line-up at the front of the bed and the canopy does not overhang. Finally, check again that the canopy is centralised and the lip on the lower edge of the canopy is not in contact with the vehicle's bodywork.



20. POSITION THE CLAMPS

Assemble the clamps loosely on the side rails. The clamps will engage into the aluminium extrusion. There are gaps left in the rubber trim in the correct positions.

If other accessories are fitted which obscure these positions, try to stay as close to them as possible.



21. TIGHTEN CLAMPS

Starting at the rear, gradually tighten the clamps with a 17mm spanner or socket.

Use a torque wrench to achieve 8Nm. Check the torque again after 30 minutes then replace the screw head covers.



22. CHECKING AND ADJUSTMENT

Check the canopy and rear door again. Small adjustments can be made if necessary by loosening and re-positioning the door strike plates. Ensure the strike remains in line with the mouth of the slam lock on the door. If necessary, loosen the clamps and adjust the position of the canopy.

TESTING

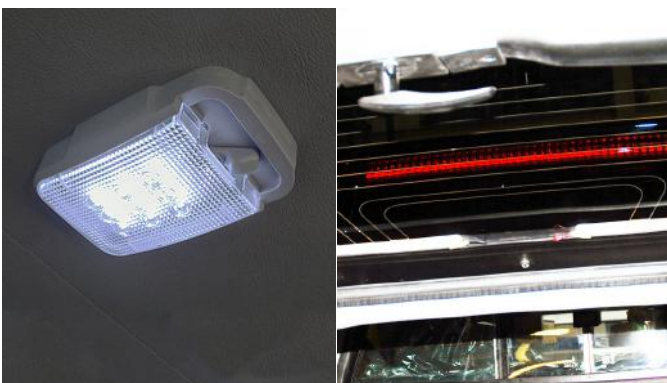

23. TESTING

Connect the harness to the canopy plug, inside the load bed and re-connect the battery.

Switch the interior light to 'door' and check it goes off when the rear door is closed.

Test the operation of the brake light.



24. TESTING (CONTINUED)

Open the protective cover on the handle, insert the key and check that the lock is turned fully clockwise. Remove the key.

Use the vehicle's key to test the remote locking. Ensure that all doors are closed.

Note: Canopy will unlock on the second operation of the remote unless the vehicle has been reprogrammed.

25. SECURE ALL CABLES AND REPLACE INTERIOR TRIM

Secure the harness connector, tidily in the front corner of the load bed. Tuck the plug under the bed rail if the liner allows.

Cable tie the harness securely to the top of the chassis rail. Leave enough loose under the rear of the cab to allow for a little 'flex' between the bed and the chassis.

Stow the fuse panel, replace the 'A' post trim, and kick panel. Replace the door aperture rubber seal and the sill cover (ensuring cables are not trapped).

TAILGATE PROTECTION

A strip of clear protection tape is supplied in the kit to prevent abrasion to the paint on the rear of the tailgate. It is cut to length for Amarok's tailgate and must be positioned so that it protects the area where the rubber seal on the bottom of the door touches.



26. CLEAN THE TAILGATE

Thoroughly clean the top part of the vehicle's tailgate and apply a fine spray of water.

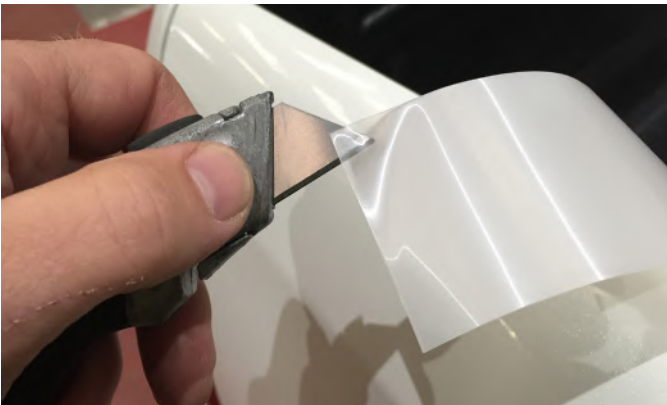

27. REMOVE THE BACKING

Use a blade to partly remove the backing film. Avoid touching the adhesive with your fingers.



28. POSITION END

Apply the tape 2-3mm away from the edge of the tailgate.

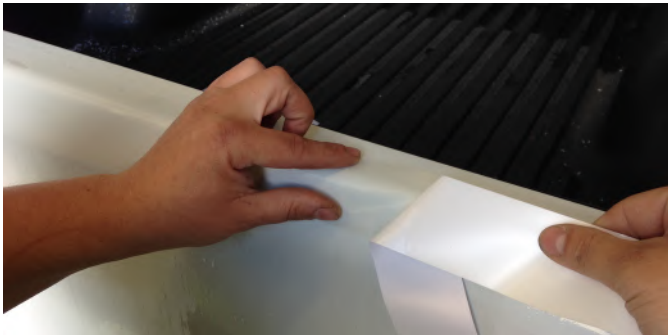
**29. LAY TAPE IN POSITION**

Peel the backing away whilst laying the tape in position.

**30. SMOOTH DOWN**

Make any adjustments to the position then use a squeegee to remove the water and any air bubbles.

**30. DRY**

Dry the area whilst making sure the position of the tape is not disturbed.

INFORMATION

This completes the installation. Please read the important information on page 11.

VARIATION FOR FITTING TO AMAROK MK1 (2013-2017)

Follow the fitting process detailed in pages 2-9 except for Page 4 step 8. See variation to step 8 below.

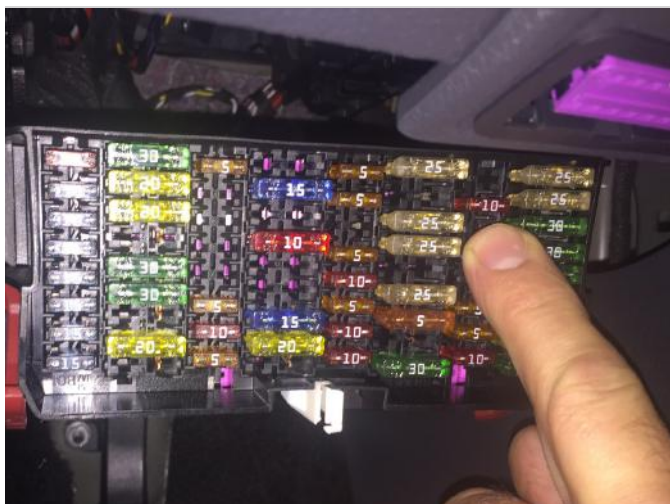

WIRE COLOUR GUIDE AMAROK MK 1(2013-17)

HARDTOP	FUNCTION	VEHICLE	NOTES
YELLOW	Central Locking (Lock)	YELLOW	- Checked on a 66 plate Amarok Momentary +12V using the remote 'lock'. Momentary +12V using the remote 'Unlock'. +12V when brake pedal is depressed. Remove fuse and replace with extension. Connect ring terminal to distribution point.
GREY	Central Locking (Unlock)	WHITE	
BLUE	Brake Light	BLACK/ RED	
RED	Interior light	FUSE POSITION SC53	
BLACK	0V to ground	BODY GROUND.	

Continue to step 9 on page 4.

FLUSH FITTING BRAKE LIGHT

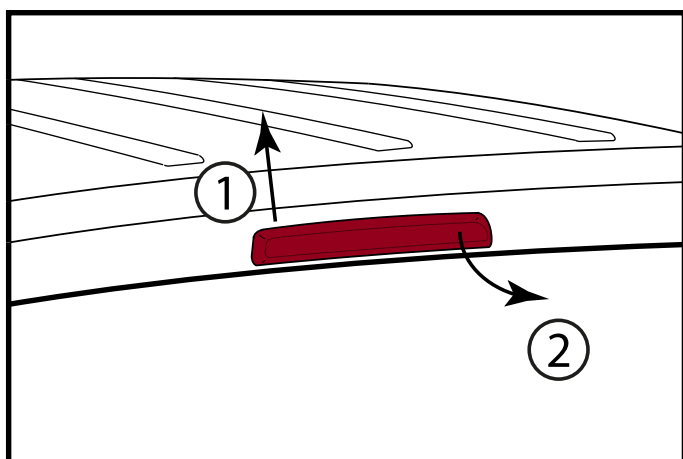

REMOVAL, DISCONNECTION & REINSTALL

Push brake light in direction of arrow 1.
Swing unit out in direction of arrow 2.

Disconnect electrical connector and re-install light unit.

Continue to section 12.

INFORMATION

IMPORTANT NOTES

Ensure the tailgate and side windows are closed when driving.

Do not place animals in the load area without adequate ventilation.

Do not exceed load limit when using roof rails.

Do not use a pressure-washer near the seals

MAINTENANCE

EVERY 3000 MILES: Check the tightness of the clamps
(8Nm Torque)

EVERY 3 MONTHS: Lubricate locks, latches and hinges
with light oil

CLEANING

Use ordinary non-ammonia based car
cleaning products and a soft cloth.

The Truckman Luxury Hardtop is designed to rely on the vehicle's central locking. It should lock and un-lock using the vehicle's key fob. The keys are provided as a back-up only.

Please leave these instructions and the hardtop keys for the user of the vehicle.

MODELS COVERED

Truckman Grand (Pop-open windows) and GLS (Sliding windows) hardtops for:
Volkswagen Amarok Mk1&2 (2013-onwards) Double cab.

These instructions are correct at time of publication only and may be amended without notice. For the latest version contact fitting@autostyling.com or call us on 01384 485 405



Auto Styling UK Limited,
Unit 14 Narrowboat Way,
Dudley, DY2 0E2, United Kingdom

Tel: 01384 485 405 **Fax:** 01384 485 453

Email: fitting@autostylinguk.com

Web: www.autostylinguk.com