

TRUCKMAN

THE UK'S LARGEST HARDTOP MANUFACTURER



KIT CONTENTS

- 1 x Set (4) Adapter plates.
- 1 x Set (4) Self adhesive gaskets.
- 8 x M8 x 25mm Screws
- 8 x Plain Washers
- 8 x M5 security nuts
- 4 x M5 Stud set
- 1 x rubber grommet
- 1 x 500mm length 4 core wire

PRE-INSTALLATION CHECKS.

Carry out a visual check of the vehicle. Clean areas of bodywork that will come into contact with, or be obscured by the product. Carry out a functional check and test of the vehicle systems prior to starting the installation, in particular, the areas to be worked on during the course of the installation.

STYLING BAR LIGHTS.

MK5 RANGER (2012-16)
MK6 RANGER (2016-)

The styling bar can be removed and re-fitted using existing plug but the wires must be extended by 500mm using the cable supplied with this kit.

DO NOT FIT THE PLUG UNTIL THE BAR IS MOUNTED ONTO THE TONNEAU

If installing to a vehicle not previously fitted with a styling bar, the brake light wires should be extended and connected to the brake light in the N/S light cluster.

If there is a brake light on the rear of the cab, this should be replaced with a blanking-plate available from Autostyling UK Ltd.

TECHNICAL HELP

Telephone: Autostyling UK Ltd 01384 485 405
Email: fitting@autostylinguk.com

1. REMOVE THE LOWER COVERS.

The front covers can be pulled downwards.
For the rear covers, first remove the clip, then the cover.

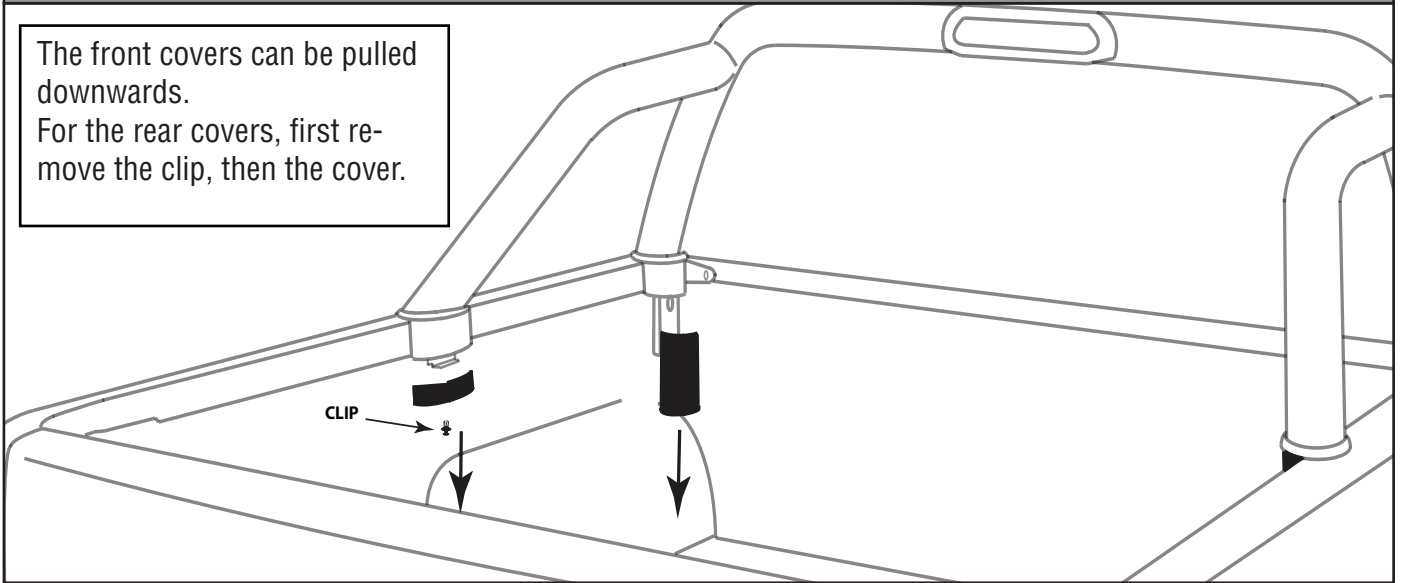

2. DISCONNECT LIGHTS.

Locate the wires in the front left corner, pull the cables free and disconnect the plug.

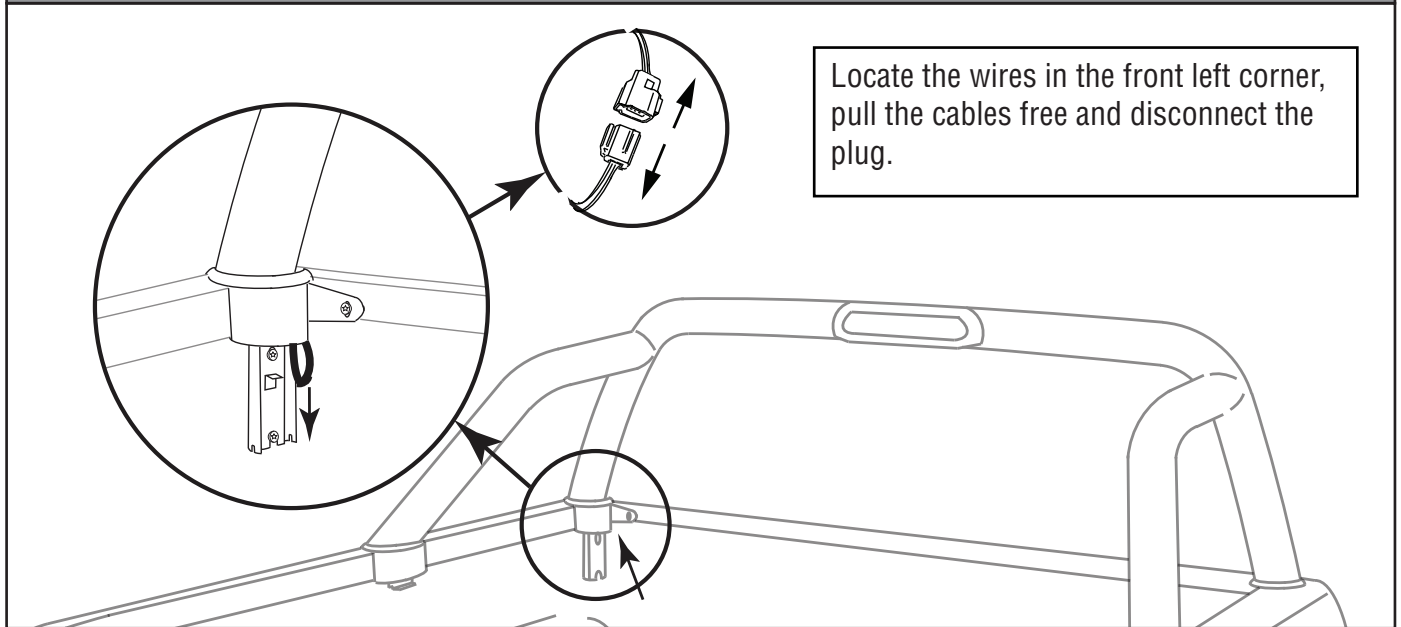

3. REMOVE THE STYLING BAR.

Remove the screws from the styling bar mountings, and lift it away from the vehicle.

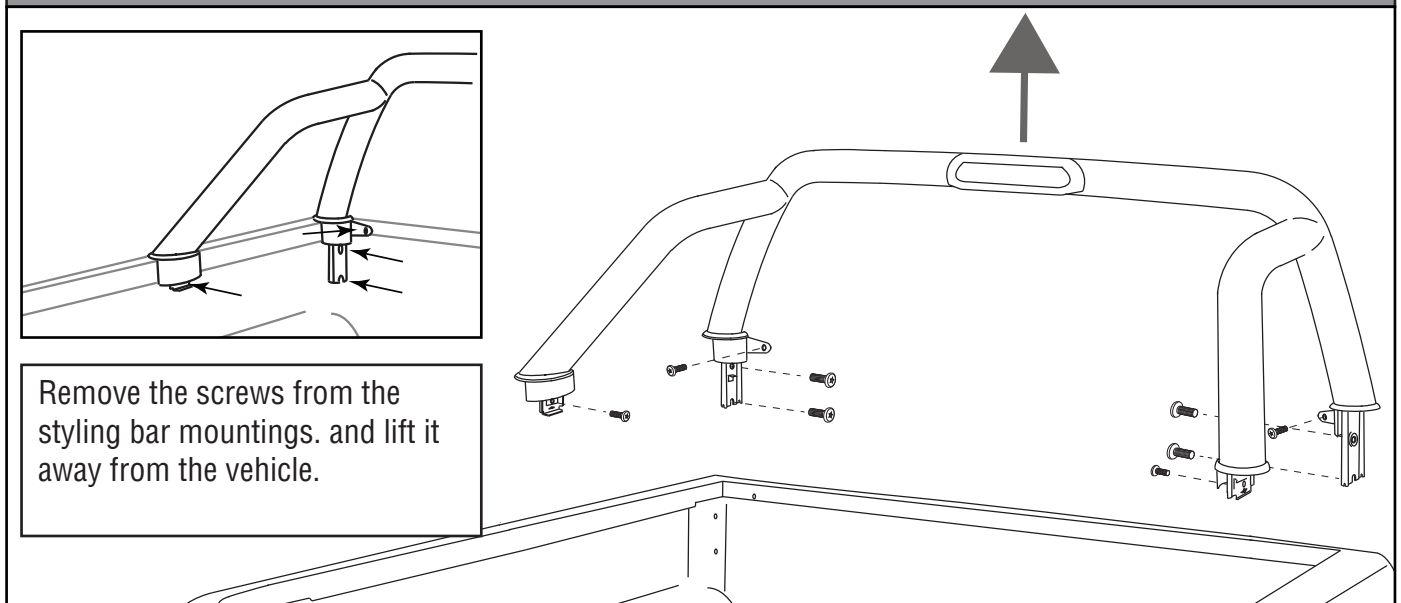

4. REMOVE THE FEET.

Turn the bar over, peel off the rubber cover pads to reveal the bracket fixing screws. Remove the screws, brackets and the rubber feet (These parts will not be required).

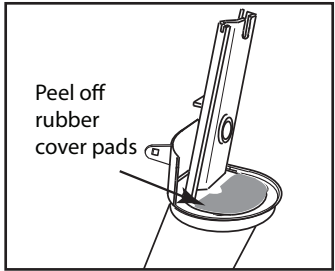
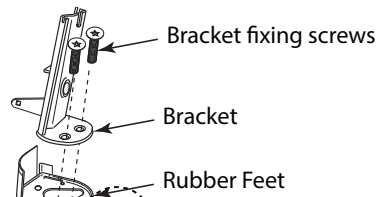

Extend these wires by 500mm using the cable supplied with the kit. Solder and heat-shrink the wire extension.

Do not re-fit the plug until step 12

6. ASSEMBLE THE ADAPTER KIT.

Assemble the adapter as shown in the diagram.

Ensure the cable emerging from the N/S/F leg of the styling bar passes through the the slots in the adapter plate but not in the self adhesive pad.

Align the plates using a straight edge as shown in the diagram below before tightening the screws.

Use thread locking solution on all 8 screws which should be tightened to 10Nm.

M8 x 25mm Screw

Washer

Self adhesive pad

Adapter plate

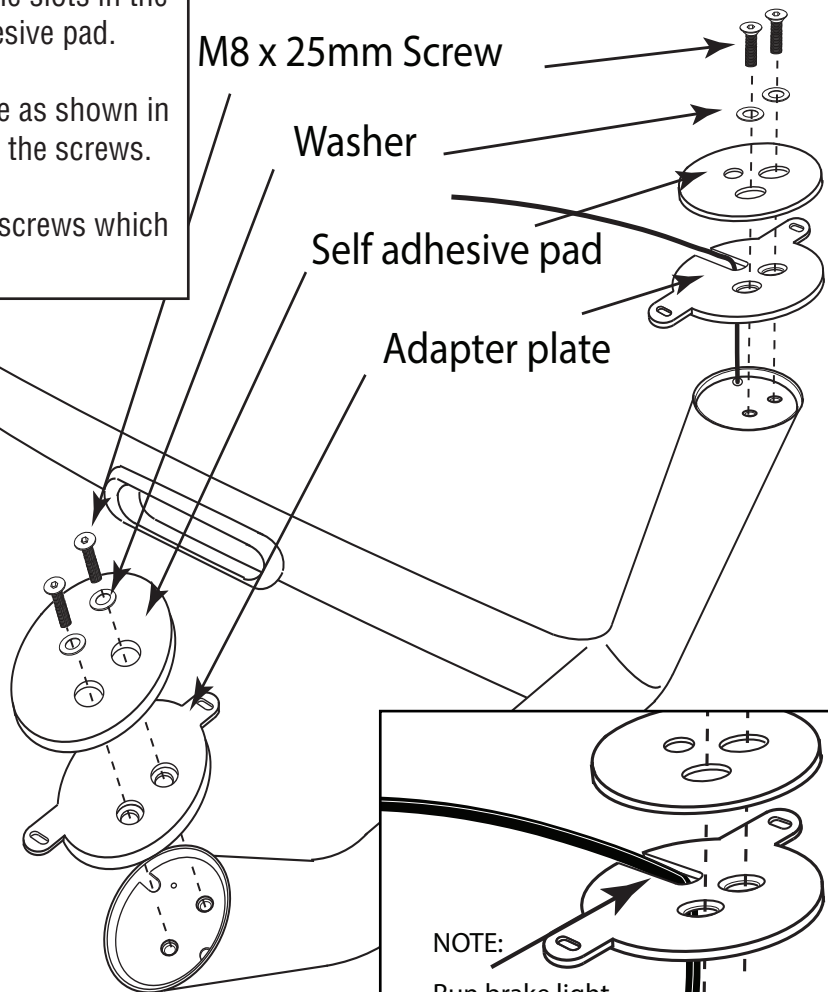
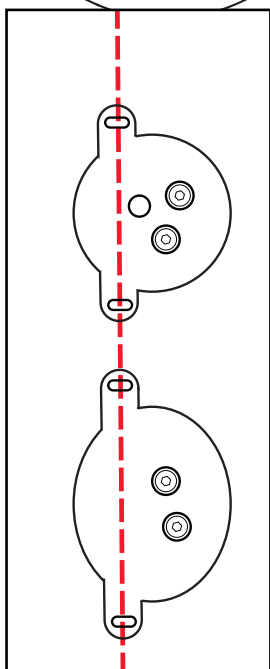

NOTE:
Run brake light wire as shown

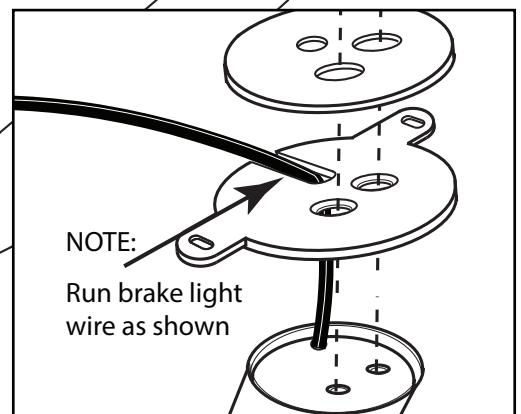

7. ASSEMBLE ROLL TOP EXTREME

Unbox the Roll Top Extreme and assemble the tonneau as per the installation instructions. Do not mount the tonneau on to the vehicle or fit the top cover at this stage.

8. DRILL HOLE FOR BRAKE LIGHT WIRE

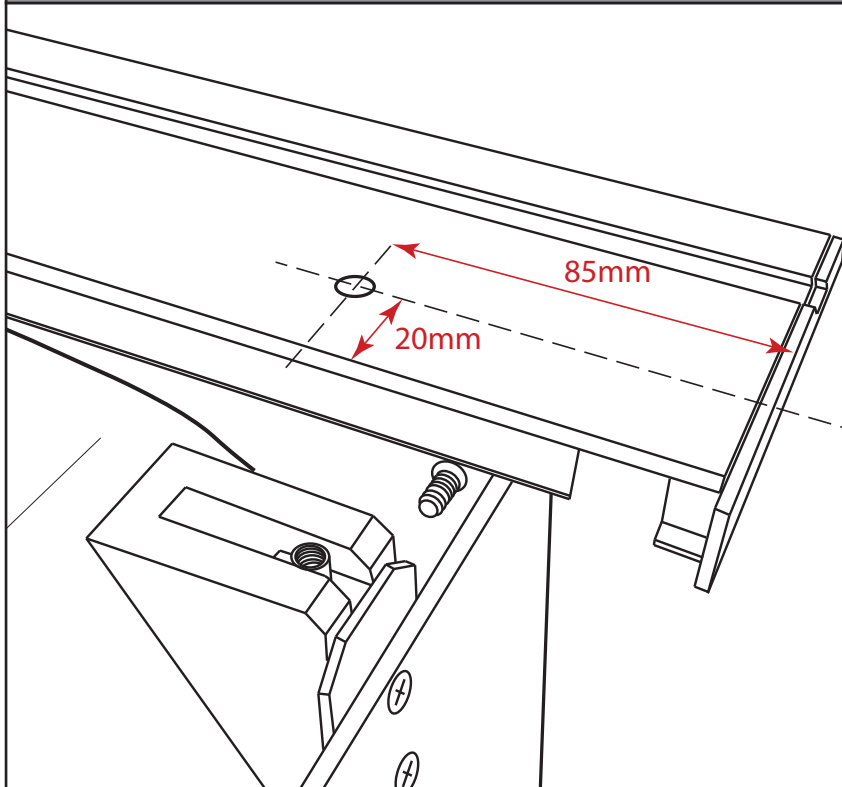

Mark out a hole position for the brake light wire. Measure 85mm from the front of the N/S rail and 20mm from the inner edge as shown.

Drill a 10mm hole, clean up any swarf then fit the grommet supplied.

9. FIT THE STUD SETS

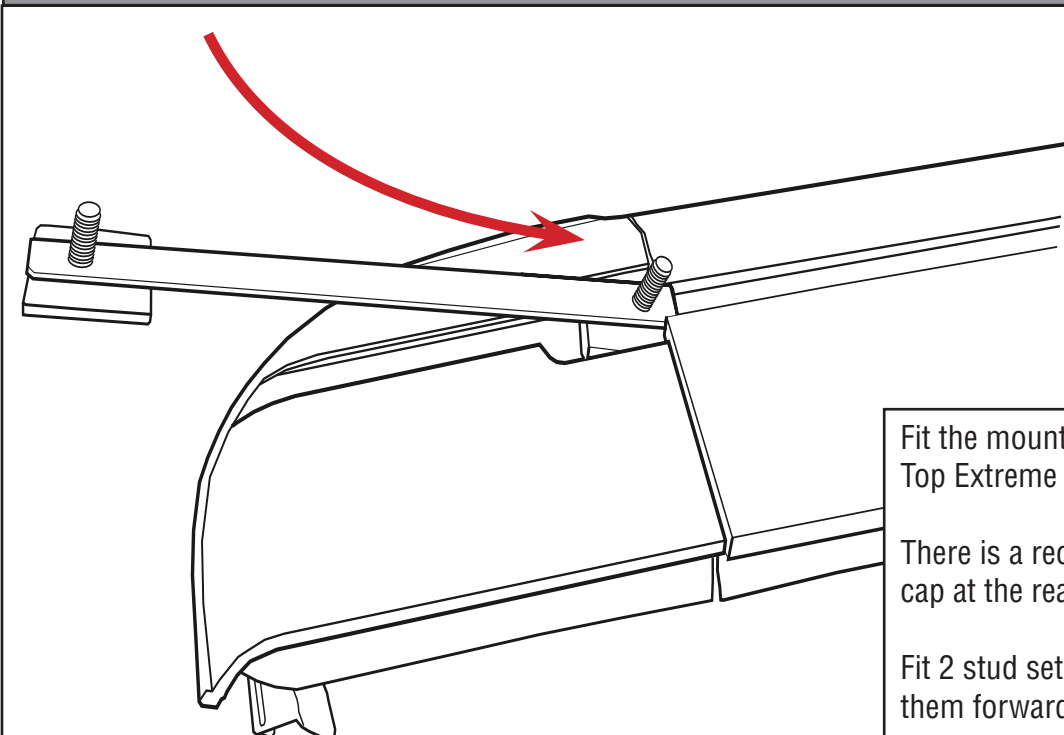

Fit the mounting studs into the Roll Top Extreme side rails as shown.

There is a recess in the plastic end cap at the rear of both rails.

Fit 2 stud sets in each rail and slide them forward.

10. MOUNT THE BAR ON TO THE TONNEAU

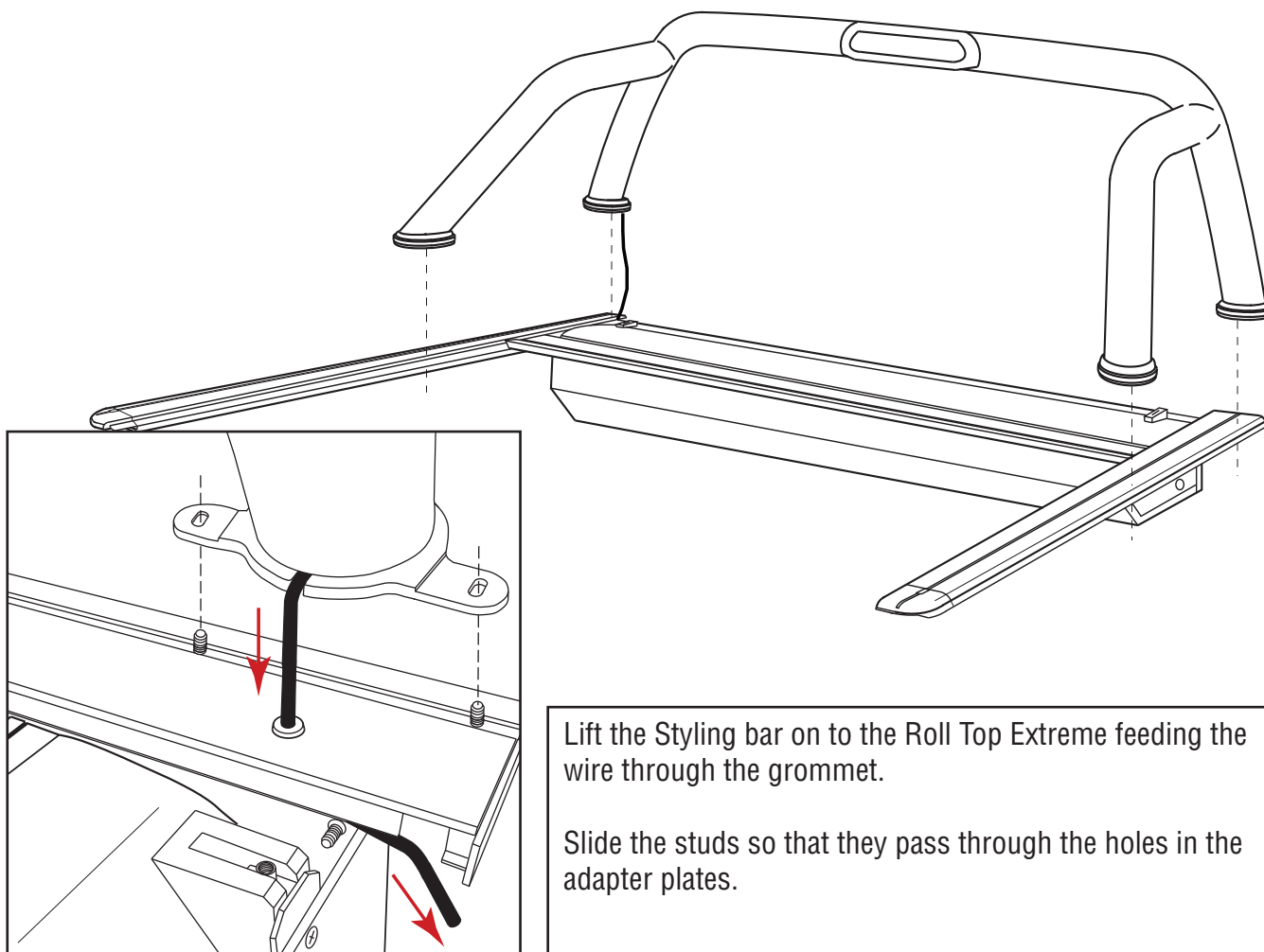

11. FIT THE SECURITY NUTS

Check the position of the adapter plates. The front plate should be 5mm from the front edge of the rail as shown.

Apply thread locking solution to the studs then fit the security nuts using the spanner supplied.

Fit the top cover of the tonneau.

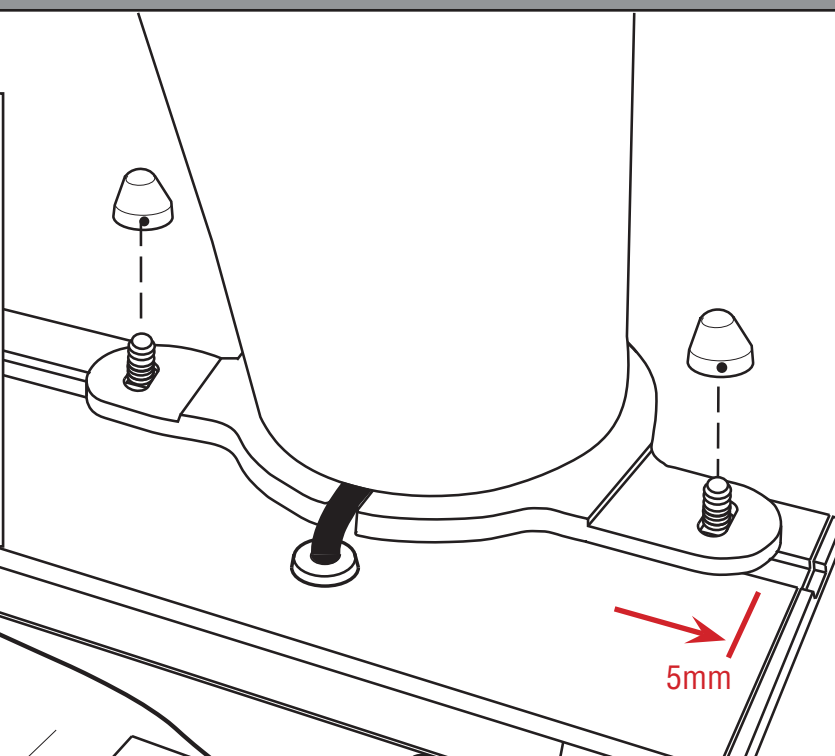

12. RE-FIT THE CONNECTOR

Solder and heat shrink the connector on to the extended wire.

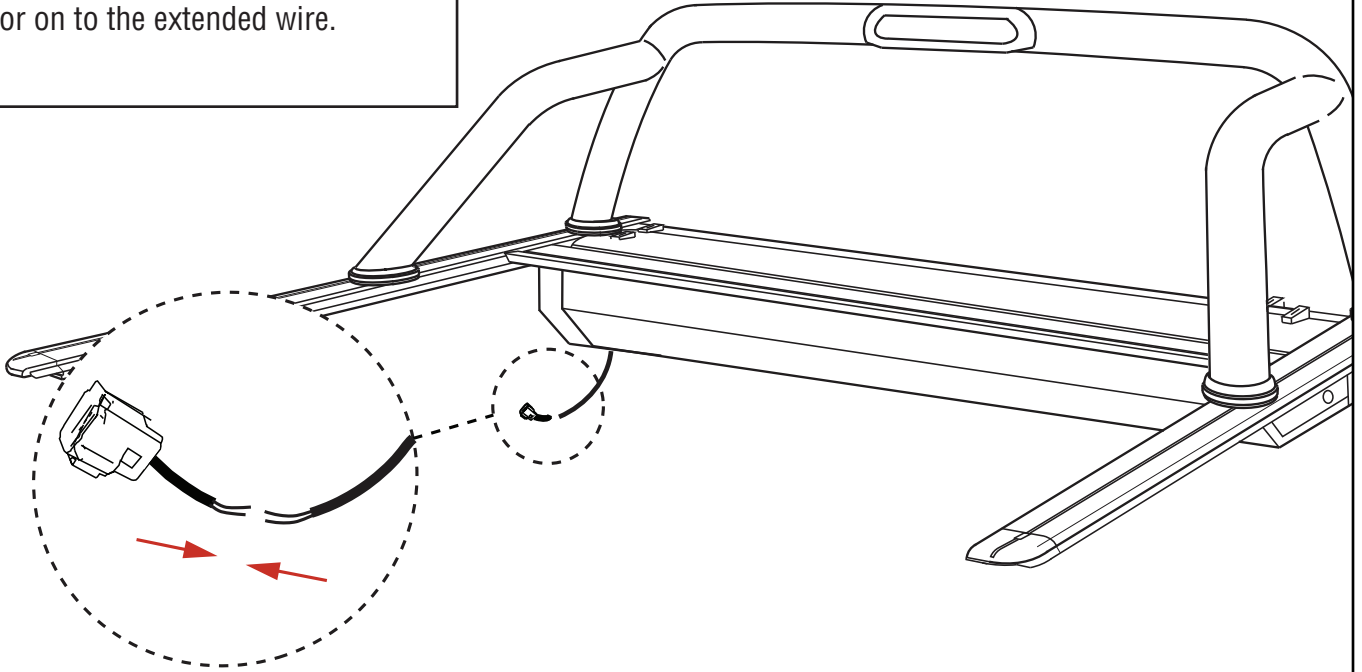

13. FIT TO THE VEHICLE.

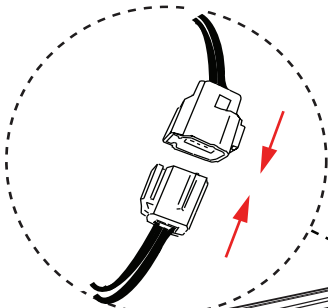

Lift the Roll Top Extreme and Styling bar assembly on to the vehicle.

Clip the connector for the brake light together before finally lowering on to the bed rails.

Test the operation of the lights before completing the fitting of the Roll Top Extreme as per the installation instructions..

NOTES

NOTES



Auto Styling Truckman Group Limited

Unit 14 Narrowboat Way,
Dudley, DY2 0E2, United Kingdom

Tel: 01384 485 405 **Fax:** 01384 485 453

Email: fitting@autostylinguk.com

Web: www.autostylinguk.com

MODELS COVERED

Ford Ranger Mk5 (2012-2016)

Ford Ranger Mk6 (2016-)

These instructions are correct at time of publication only and may be amended without notice. For the latest version contact fitting@autostyling.com or call us on 01384 485 405